

INSTALLATION INSTRUCTIONS**MODEL NO. 82650**

Rev. 1

APPLICATION:**CHEVROLET/GMC**

1992-94 Chevrolet Blazer (full size)
 1996-04 Chevrolet/GMC Van (full size)
 1983-04 Chevrolet S-10 P/U (short bed, EXC Sport Side)
 GMC S-15 & Sonoma P/U (short bed)
 1983-99 Chevrolet S-10 P/U (long bed)
 GMC S-15 & Sonoma P/U (long bed)
 1992-06 Chevrolet/GMC Suburban
 1995-06 Chevrolet Tahoe, GMC Yukon & Yukon XL

ISUZU

1998-04 Isuzu Hombre P/U

CHRYSLER/DODGE/PLYMOUTH

1986-04 Chrysler Town & Country Van (all)
 Dodge Caravan (all)
 Dodge Dakota P/U (short bed)
 1986-99 Dodge Dakota P/U (long bed)
 1978-94 Dodge Ramcharger
 1984-95 Plymouth Voyager Van (all)

FORD

1989-97 Ford Aerostar Van (extended only)
 1978-96 Ford Bronco
 1983-90 Ford Bronco II
 1982-07 Ford Ranger P/U (except 98-02 Flareside)

JEEP

1984-01 Jeep Cherokee
 1993-98 Jeep Grand Cherokee
 2001-07 Jeep Liberty

MAZDA

1990-07 Mazda P/U (except 1998-02 Flareside)

NISSAN

1987-04 Nissan P/U & Frontier

TOYOTA

1984-94 Toyota P/U
 1995-04 Toyota Tacoma P/U

WARNING: Although this hitch is designed to safely tow its rated load, we recommend that you consult your vehicle owner's manual for possible manufacturer's recommendations or limitations. Trailer brakes are recommended for towing loads in excess of 1500 lbs. Always follow the manufacturer's installation instructions and always install on the specified vehicle. Before installing hitch, check that the attachment points are in good condition.

Failure to follow these guidelines will void warranty. Any modifications to this hitch will void warranty.

WARNING: Use only a 5/8" diameter hitch pin with locking device to secure a ball mount in this receiver. Be sure to check the hitch pin and hair pin for positive locking placement before towing trailer.

NOTE: Some states require a clear view of license plates. Remove trailer ball and/or ball mount when not in use if it restricts view.

COMPLETE PARTS LIST

Item	Part #	Description	Quantity
1.		Receiver Cross Tube Assembly	1
2.	1938-04	Left Frame Bracket	1
3.	1941-07	Right Frame Bracket	1
4.	1946-02	Support Bracket	2
5.	4349-09	Square Hole Plate 2"	6
6.	1417-03	Square Hole Plate 3"	2
7.	1953-01	3/8 Spacer Plate	2
8.	1027-03	1/2 Spacer Plate	4
9.	1281-06	5/8-11 x 2-1/2 Hex Bolt	2
10.	4430-03	1/2-13 x 3-1/4 Hex Bolt	2
11.	1840-03	1/2-13 x 2-1/2 Hex Bolt	2
12.	1838-03	1/2-13 x 2 Hex Bolt	2
13.	2866-02	1/2-13 x 2 Carriage Bolt	6
14.	2372-04	12mm x 1.75 x 40mm Hex Bolt	2
15.	4438-03	3/8-16 x 2 Hex Bolt	2
16.	1863-03	5/8-11 Hex Nut	2
17.	1862-03	1/2-13 Hex Nut	10
18.	4034-05	1/2-13 Hex Nylon Lock Nut	2
19.	2536-02	12mm x 1.75 Hex Nut	2
20.	1860-03	3/8-16 Hex Nut	2
21.	2283-05	3/8-16 Hex Flange Lock Nut	1
22.	1881-03	5/8 Lockwasher	2
23.	1880-03	1/2 Lockwasher	10
24.	1843-03	5/8 Flatwasher	6
25.	1888-03	1/2 Flatwasher	12
26.	4892-07	Pull Wire (Not Shown)	1

CLASS III**WEIGHT CARRYING HITCH CAPACITY**

4,000 LBS. MAXIMUM TRAILER WEIGHT
 400 LBS. MAXIMUM TONGUE WEIGHT

WEIGHT DISTRIBUTING HITCH CAPACITY

5,000 LBS. MAXIMUM TRAILER WEIGHT
 500 LBS. MAXIMUM TONGUE WEIGHT

GENERAL INSTALLATION INSTRUCTIONS

1. Insert the left and right frame brackets #2 and #3 into the respective ends of the receiver cross tube #1. Position the frame brackets so that they are the same width as the vehicle side frame. Loosely secure with 1/2" fasteners #10 and #18 as shown on Illustration below. Support brackets #4 are not used on every application
2. Remove the spare tire from its storage location if it interferes with placement of the hitch. It will be put back in place after hitch is installed.
3. Referring to Page 1, find and follow correct instructions and illustrations for your particular vehicle.
4. Some applications will use the Pull Wire to position fasteners into box vehicle frames. Follow instructions shown on Pull Wire Illustration for this operation.
5. After hitch is installed, be sure all bolts are tightened to specified torque shown below.
3/8" fasteners-35 ft. lbs. torque
12mm fasteners-75 ft. lbs torque
1/2" fasteners-75 ft. lbs torque
6. Place spare tire back up into its storage location, if it was removed for hitch installation.

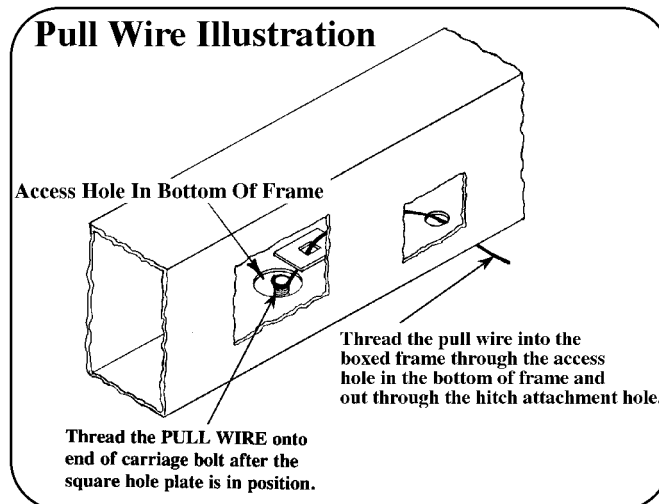
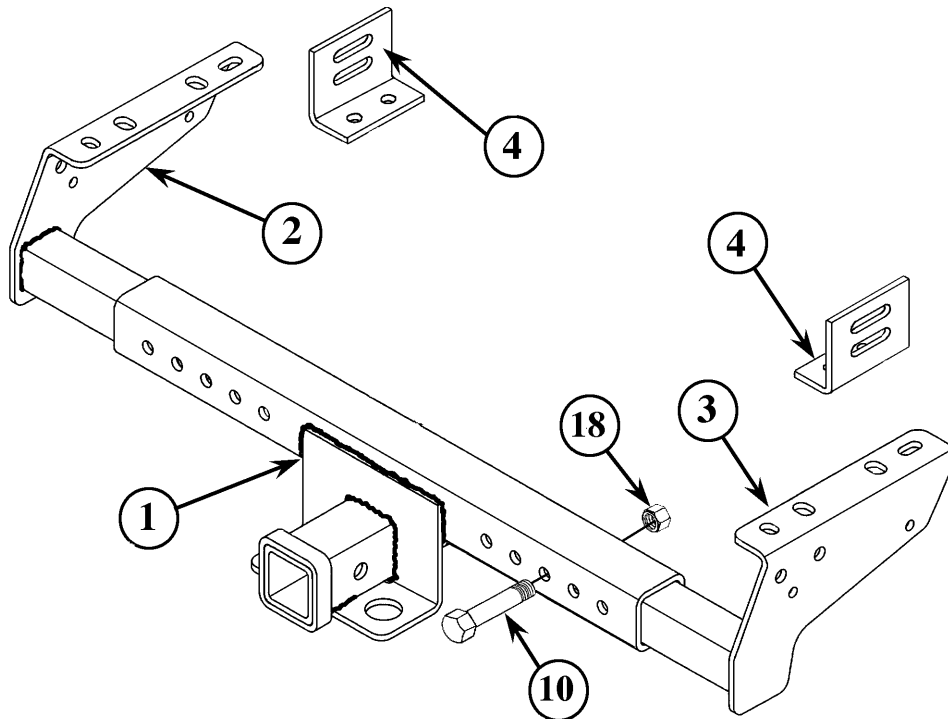

INSTALLATION 1

1986-04 DODGE CARAVAN, PLYMOUTH VOYAGER, CHRYSLER TOWN & COUNTRY

1. Assemble a 1/2" carriage bolt #13 and square hole plate #5 with the pull wire. Position these parts into the vehicle box frame through the large access hole in bottom of frame and pull bolt out of frame through smaller holes in frame that match up with holes in hitch frame bracket. If forward holes are not in vehicle frame, they must be drilled, using forward hole in each hitch frame bracket as guides.
2. Position hitch assembly up against bottom of vehicle frame so that previously installed bolts will go through the two holes in frame bracket as shown on Illustration. Some vehicles will have a small flange on the bottom of the frame that will have to be bent up slightly so hitch can be positioned correctly. Bolt hitch securely in place as illustrated.
3. Tighten all 1/2" bolts to 75 ft. lbs. torque. Failure to tighten bolts as described may result in fastener loss or failure.

1986-04 DODGE DAKOTA P/U (long bed)

1. Position hitch assembly up against bottom of truck frame so that frame brackets are even with end of truck frame. Drill 1/2" attachment holes in truck frame using the front and rear holes in hitch frame brackets as guides. See Illustration 1.
2. Place 1/2" carriage bolts #13 with square hole plates #5 down through frame and bolt hitch frame brackets in place as illustrated.
3. Tighten all 1/2" bolts to 75 ft. lbs. torque. Failure to tighten bolts as described may result in fastener loss or failure.

1978-96 FORD BRONCO (full size)

1. Position the hitch assembly so that the frame brackets are even with the ends of the vehicle frame. Place 1/2" spacer plates #8 between the truck frame and frame brackets. Clamp hitch in place. Drill 1/2" attachment holes in frame using the front and rear holes in frame brackets as guides.
2. Attach hitch to vehicle frame with 1/2" carriage bolts #13 and square hole plates #5 as illustrated. Use the pull wire to position bolts between gas tank and frame at forward holes.
3. Tighten all 1/2" bolts to 75 ft. lbs. torque. Failure to tighten bolts as described may result in fastener loss or failure.

1992-06 SUBURBAN, 1995-06 TAHOE, 1992-94 BLAZER (full size), 1995-06 YUKON, 1995-06 YUKON XL, 1996-04 CHEVY/GMC VAN (full size)

1. Position hitch assembly against bottom of the frame with the rear most frame bracket hole in line with the existing hole in each vehicle frame. Place 1/2" carriage bolts #13 with square hole plates #5 down through hole in frame and bolt hitch frame brackets in place.
2. Using the forward most hole in each frame bracket as a guide, drill a 1/2" attachment hole in vehicle frame. Place 1/2" carriage bolts #13 with square hole plates #5 down through frame and bolt hitch frame brackets in place.
3. Tighten all 1/2" bolts to 75 ft. lbs. torque. Failure to tighten bolts as described may result in fastener loss or failure.

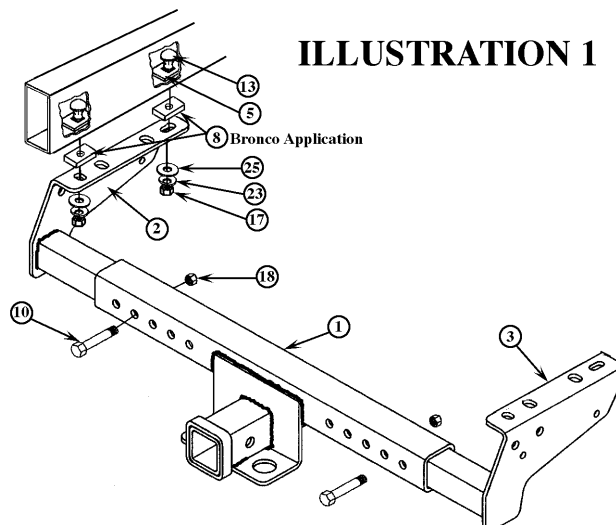

INSTALLATION 2

1986-04 CARAVAN, VOYAGER, TOWN & COUNTRY

1. Remove spare tire from its storage location. It will be reinstalled after hitch is in place.
2. Loosen the rear bolt in bottom of each frame member. This will allow easier bolt and plate placement inside boxed frame.
3. Using the pull wire, insert a carriage bolt #13 and the long square hole plate #6 into boxed frame through end of frame and pull bolt out through slot in bottom of frame. Repeat on other side of vehicle. Tighten the factory bolts loosened in Step 2 to 75 ft. lbs. torque.
4. Carefully position hitch assembly up against the bottom of vehicle frame so third hole from back of frame bracket lines up with previously installed carriage bolt. Place a 1/2" spacer plate #8 between frame bracket and frame. Bolt frame brackets in place at these bolts.
5. Using the rear most hole in each hitch frame bracket as guides, drill a 1/2" hole in bottom of each bumper bracket/frame.
6. Place a short square hole plate #5 between the hitch frame bracket and vehicle bumper bracket in line with the drilled hole. Use the pull wire to position a carriage bolt #13 and a short square hole spacer #5 into bumper bracket so that bolt drops out through the drilled holes, spacer plate and hitch frame bracket. Bolt hitch securely in place as illustrated.
7. Tighten all 1/2" bolts to 75 ft. lbs. torque. Failure to tighten bolts as described may result in fastener loss or failure. Reposition spare tire into its storage location if it was removed in Step 1.

ILLUSTRATION 2

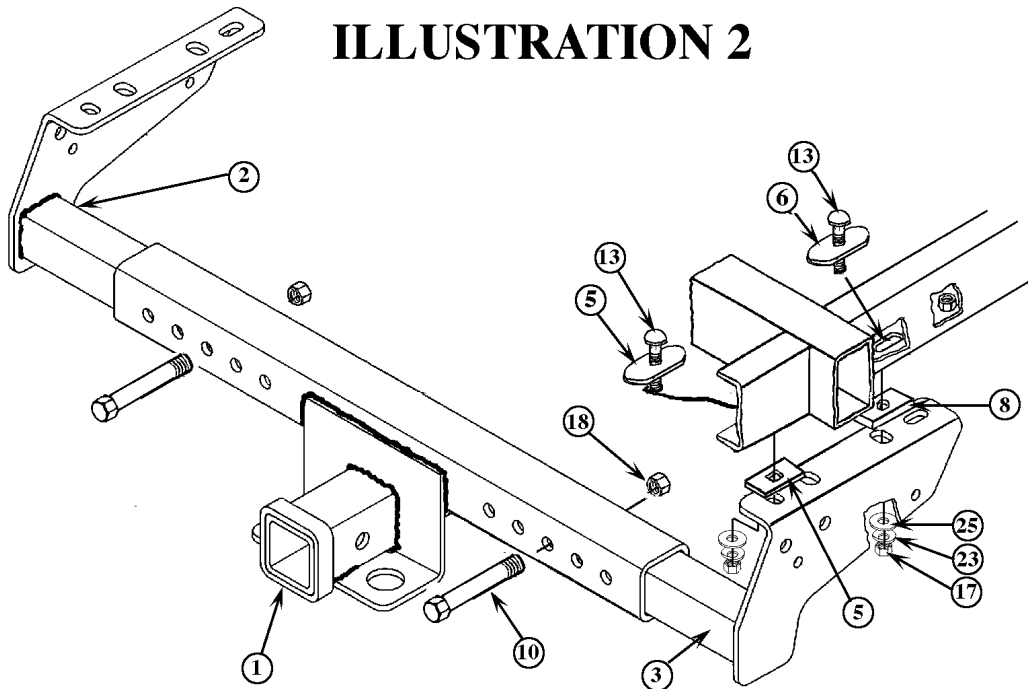

INSTALLATION 3

1983-99 CHEVY S-10/GMC S-15/SONOMA LONG BED P/U

1. Clamp hitch assembly up against bottom of vehicle frame so that Hole 2 is lined up under the large hole in each frame. Place a long square hole plate #6 over the large hole in each frame and bolt hitch in place as shown on Illustration 3.
2. Using Hole 4 in hitch frame bracket as a guide, drill a 1/2" hole in each vehicle frame. Place a 1/2" carriage bolt #13 into a short square hole plate #5 and drop bolt down through drilled hole in frame and hitch frame bracket hole. Bolt hitch securely in place.
3. Tighten all 1/2" bolts to 75 ft. lbs. torque. Failure to tighten bolts as described may result in fastener loss or failure.

1974-94 DODGE RAM CHARGER

1. Clamp hitch assembly up against bottom of vehicle frame with the rearmost hole in each frame bracket over the rivet in vehicle frame. Mark and drill 1/2" attachment holes in vehicle frame at Hole 2 and Hole 4 in hitch frame brackets. As shown on Illustration 3a.
2. Remove hitch assembly from frame and install four carriage bolts #13 and a short square hole plates #5 into vehicle frame using the pull wire.
3. Place a 1/2" spacer plate #8 between hitch frame bracket and vehicle frame at each attachment hole. Bolt hitch frame brackets securely in place as illustrated.
4. Tighten all 1/2" bolts to 75 ft. lbs. torque. Failure to tighten bolts as described may result in fastener loss or failure.

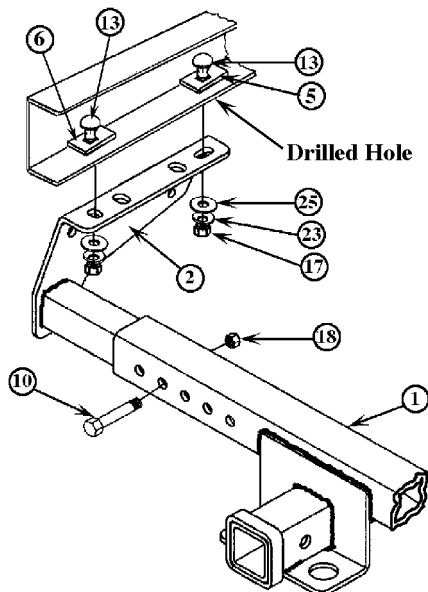

ILLUSTRATION 3

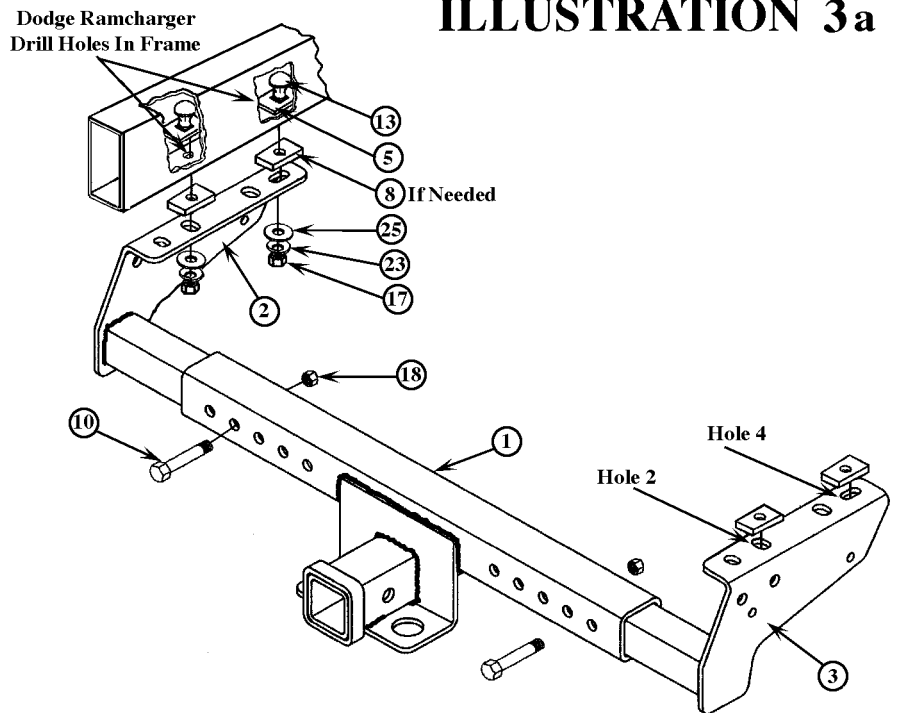

ILLUSTRATION 3a

INSTALLATION 4

1983-04 CHEVROLET S-10/EXTREME SHORT BED P/U

1983-04 GMC S-15/SONOMA SHORT BED P/U

1998-04 ISUZU HOMBRE SHORT BED P/U

1. Remove the tailpipe hanger bracket from truck frame. Remove the metal bracket from rubber doughnut and discard bracket.
2. Position the hitch assembly up against the bottom of truck frame so that Hole 3 in hitch frame brackets is in line with the existing hole in each frame. Bolt frame bracket in place with 1/2" fasteners as illustrated.
3. Using the hole in side of each hitch frame bracket as a guide, drill a 1/2" hole in truck bumper bracket and bolt in place with fasteners shown on Illustration 4.
4. Attach the rubber tailpipe hanger to hole in side of right frame bracket with 3/8" bolt #15 and 3/8" flange locknut #21. Tighten locknut snugly against rubber hanger.
5. Tighten all 1/2" bolts to 75 ft. lbs. torque. Failure to tighten bolts as described may result in fastener loss or failure.

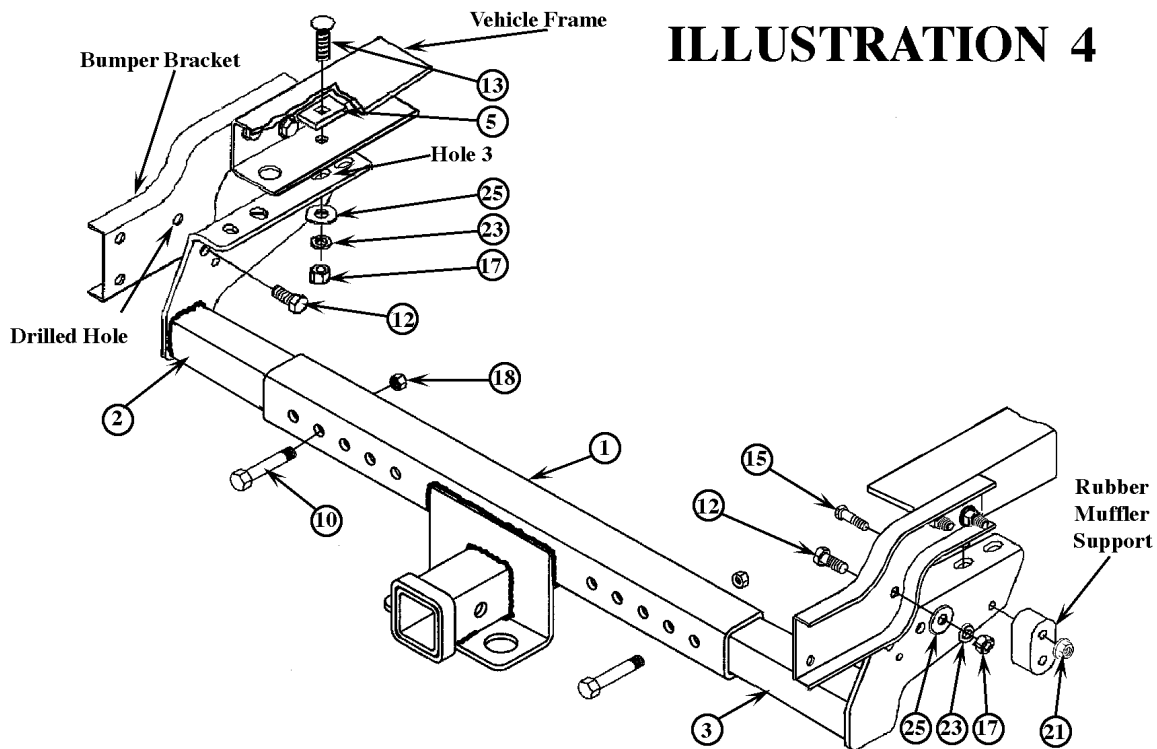

INSTALLATION 6

1982-07 RANGER P/U

1990-07 MAZDA P/U

NOTE: If right and left hitch frame brackets were installed onto cross tube of hitch, remove them for this installation.

1. Lower the spare tire. Remove the bolts that attach the left bumper bracket to the bottom of the frame. Remove the clip nuts from the bottom of the frame. Support bumper after removing bolts. Remove the bumper brace from the bumper and bumper bracket.
NOTE: On 1998-03 models, use a T50 TORX wrench to remove the bumper bolts. Save fasteners for later use.
2. Slide the receiver cross tube onto the installed left frame bracket tube. remove the right side bumper bracket and bumper brace. Slide the right side frame bracket #3 onto the receiver cross tube and position up against the bottom of the right side frame. Bolt bumper bracket and hitch frame bracket in place as described in Step 2.
3. Place three 1/2" carriage bolts #13 with square hole plates #5 into the existing holes in truck frame. Place a 1/2" flat washer #25 at each attachment bolt between truck frame and left hitch frame bracket. Place the bumper bracket under the hitch frame brackets and bolt all parts loosely in place.
4. Bolt bumper braces, removed in Step 1, to new bumper location as illustrated. Use original fasteners. Place spare tire back into its storage location.
5. Tighten all 1/2" bolts to 75 ft. lbs. torque. Failure to tighten bolts as described may result in fastener loss or failure.

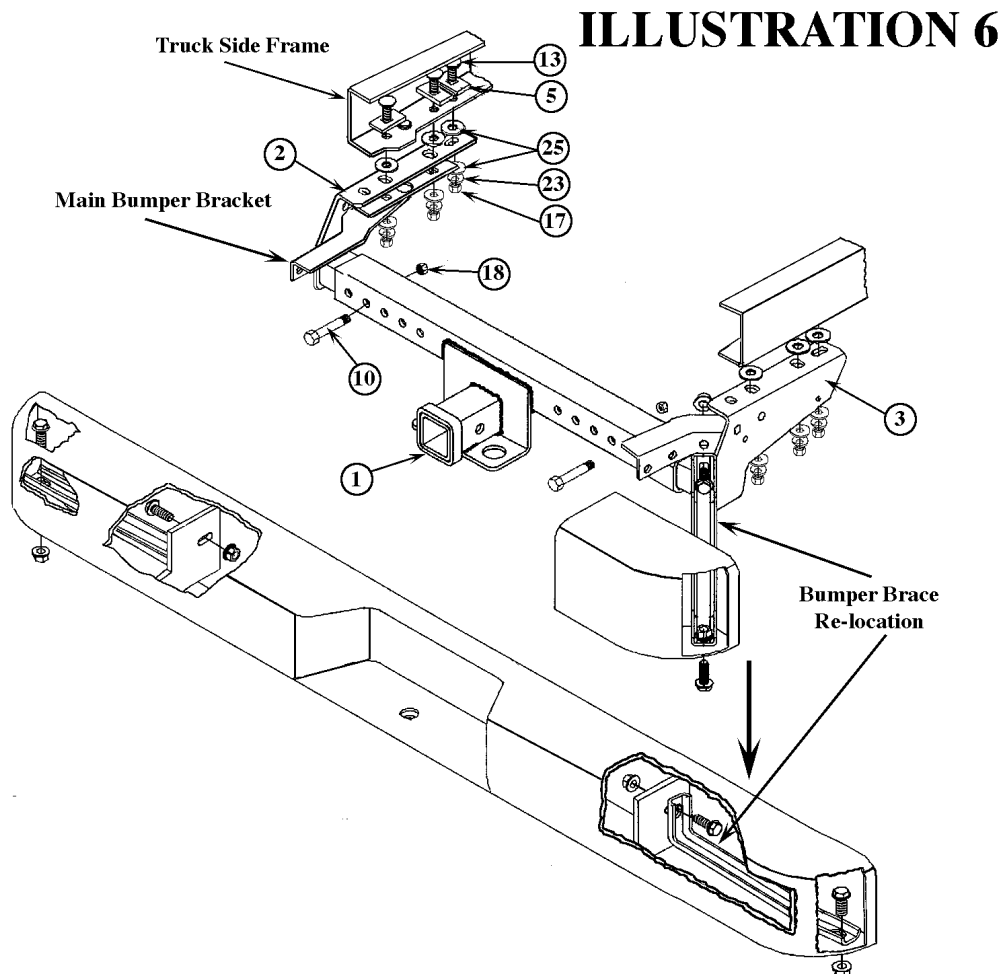

INSTALLATION 7

1986-04 DODGE DAKOTA Short Bed

1. Enlarge the existing hole in the bottom of each end of vehicle frame to 5/8" diameter. Place a 5/8" bolt #9 with 5/8 flat-washer #24 and spacer plate #7 down through enlarged hole in each frame end.
2. Position hitch assembly up against bottom of vehicle frame so that previously installed 5/8 bolt drops through Hole 3 in left and right frame brackets #2 and #3. Place a 5/8 flatwasher #24 between frame brackets and vehicle frame and bolt hitch in place, as illustrated. Flatwasher will space hitch away from rivets in vehicle frame. Tighten bolts so that hitch is level.
3. Attach support brackets #4 to hitch frame brackets with 1/2" fasteners as illustrated.
4. Using one of the slots in each support bracket #4 as a guide, drill a 1/2" diameter hole in vertical side of each bumper bracket. Bolt support brackets in place as illustrated.
5. Tighten all 1/2" bolts to 75 ft. lbs. torque and 5/8 bolts to 160 ft. lbs torque. Failure to tighten bolts as described may result in fastener loss or failure.

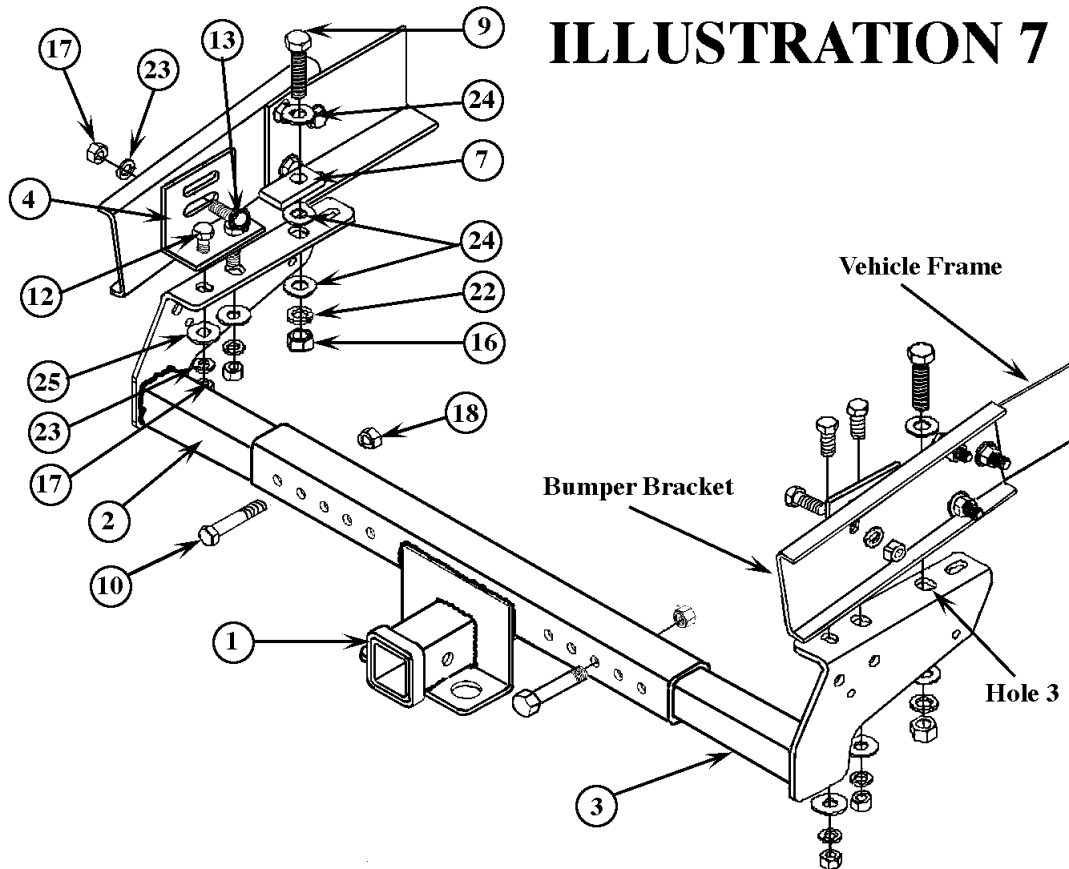

INSTALLATION 8

1987-04 NISSAN P/U 1995-04 TOYOTA TACOMA P/U

NOTE: For Tacoma applications, modifications may have to be made to the exhaust system and a hole may have to be drilled in bumper bracket to install hitch.

1. Remove the rear bolt from bottom of vehicle frame end. Place two 1/2" spacer plates #8 between vehicle frame and hitch frame bracket at this location. Bolt hitch frame bracket to vehicle frame at Hole 3 using bolt #11 as illustrated.
2. Place the support bracket #4 over Holes 1 and 2 on each hitch frame bracket. Bolt parts together with hex bolt #12 at Hole 1 and carriage bolt #13 at Hole 2. Bolt support bracket to bumper bracket at existing hole using a carriage bolt #13. If no hole exists, a hole must be drilled using one of the slots in the support bracket as a guide.
3. Tighten all 1/2" bolts to 75 ft. lbs. torque. Failure to tighten bolts as described may result in fastener loss or failure.

1997-04 NISSAN FRONTIER 2 & 4 DR.

1. Remove the bolt from the bottom of vehicle frame. Reinstall bolt with head on the bottom of the frame. Position hitch assembly up against the bottom of the frame, behind previously repositioned bolt, with 1/2" spacer plate #8 between frame and hitch frame bracket at Hole 3. The forward end of the hitch bracket may overlap the head of the existing bumper bracket bolt. Drill a 1/2" attachment hole in frame using Hole 3 as a guide. Bolt frame brackets securely to frame with fasteners shown.
2. Place the support bracket #4 over Holes 1 and 2 in frame bracket and bolt securely in place. Using the top slot in support brackets as guides, drill 1/2" hole in each bumper bracket. Use carriage bolts and fasteners shown to secure support bracket to bumper bracket.
6. Tighten all 1/2" bolts to 75 ft. lbs. torque. Failure to tighten bolts as described may result in fastener loss or failure.

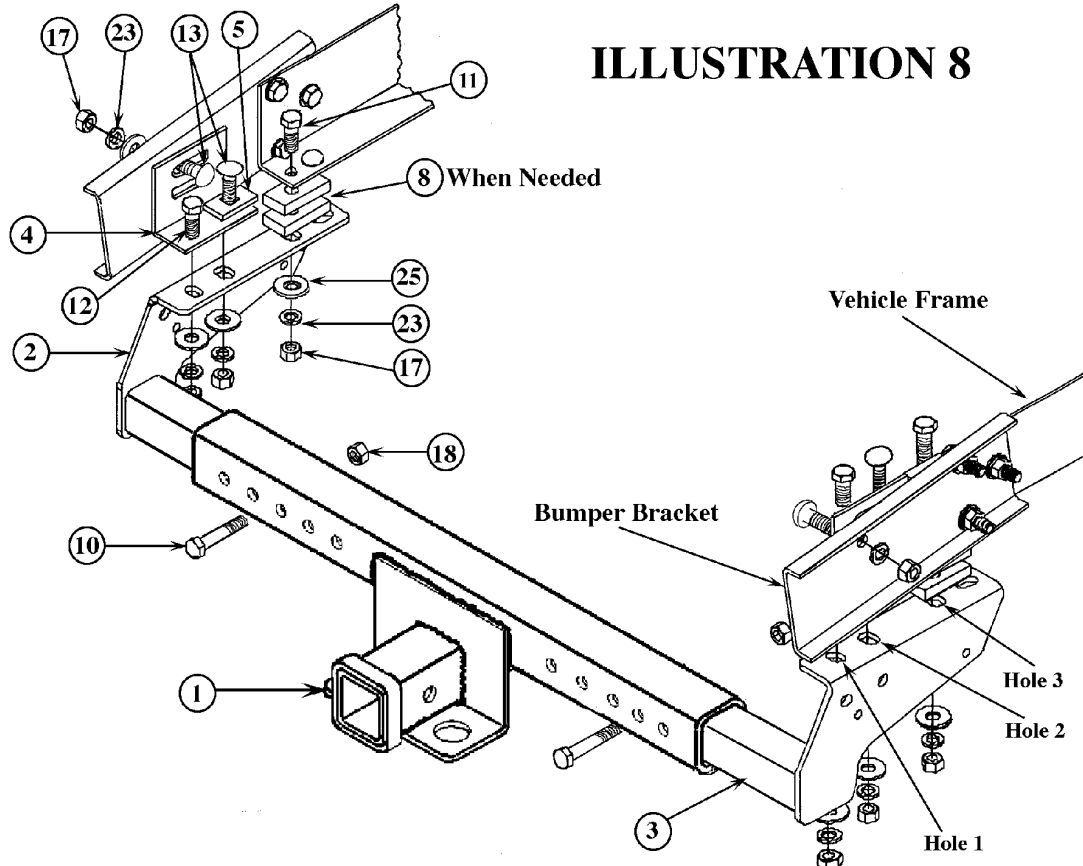

INSTALLATION 10

1984-01 JEEP CHEROKEE

(with steel gas tank protector and fasteners in frame)

1. Loosen the tailpipe hanger clamp from the tailpipe. Loosen the bolts which attach the tailpipe hanger bracket to the bottom of the frame. Remove the 12mm bolts which attach the steel gas tank protector to the side frame of vehicle. NOTE: It may be necessary to bend the steel tank protector in slightly to give hitch adequate clearance.
2. Position the hitch assembly up against the bottom of vehicle side frame with the right frame bracket positioned under the tailpipe hanger bracket. Bolt in place with previously removed 12mm bolts. Tighten the tailpipe hanger attachment bolts.
4. Tighten all 12mm bolts to 75 ft. lbs. torque. Failure to tighten bolts as described may result in fastener loss or failure.
5. Adjust the tailpipe to clear the hitch frame bracket. Tighten tailpipe clamp.

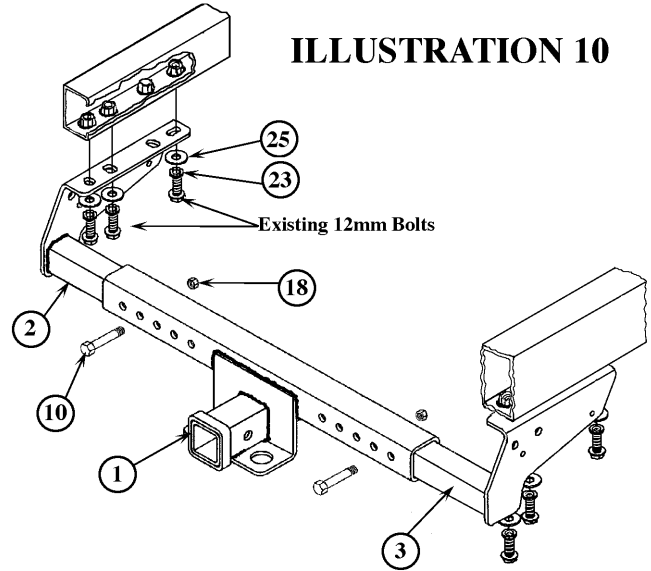

INSTALLATION 11

1984-01 JEEP CHEROKEE

(without gas tank protector)

1. Remove the two nuts holding the tailpipe hanger bracket to the vehicle frame. Remove the rear stud from bottom of passenger side vehicle frame. Remove existing 12mm bolts from bottom of frame.
2. Using the pull wire, insert three carriage bolts #13 with short square hole plates #5 into driver side frame so that bolts will drop out through existing holes in the frame as illustrated.
3. Position hitch assembly up against bottom of vehicle frame and bolt in place with existing 12mm bolts on passenger side and previously installed carriage bolts on driver side.
4. Tighten all 12mm bolts and 1/2" bolts to 75 ft. lbs. torque. Failure to tighten bolts as described may result in fastener loss or failure.
5. Reinstall the tailpipe hanger bracket under the hitch frame bracket.

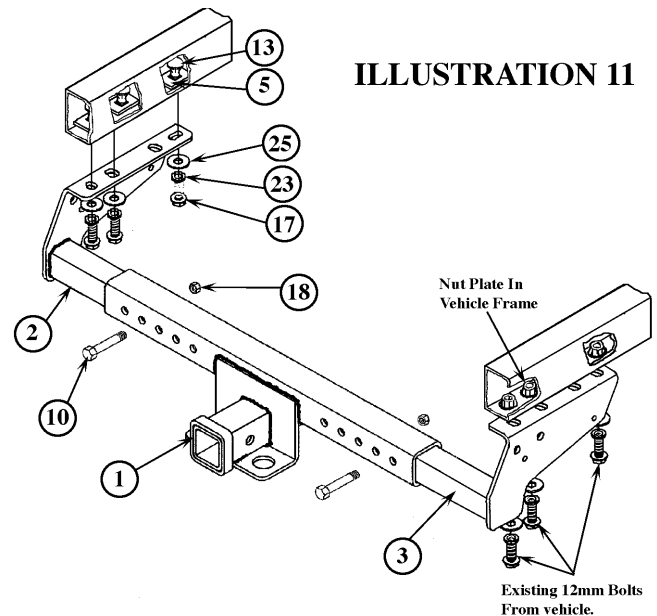

INSTALLATION 12

1993-98 JEEP GRAND CHEROKEE

1. Remove the 12mm nuts from two studs in bottom of both vehicle frames. Save for re-use. Remove factory installed tow hook if so equipped.
2. Position the hitch assembly up against the bottom of vehicle frame with studs aligned with Holes 2 and 3 in hitch frame brackets. Bolt in place as illustrated.
3. Using Hole 1 in hitch frame bracket as a guide, drill a 1/2" hole in each vehicle frame. Insert a carriage bolt #13 with a short square hole plate #5 into vehicle frame with pull wire. Insert pull wire into end of frame above bumper bracket and pull out through drilled hole. Bolt frame brackets in place as illustrated.
4. Tighten all 12mm bolts and 1/2" bolts to 75 ft. lbs. torque. Failure to tighten bolts as described may result in fastener loss or failure.

ILLUSTRATION 12

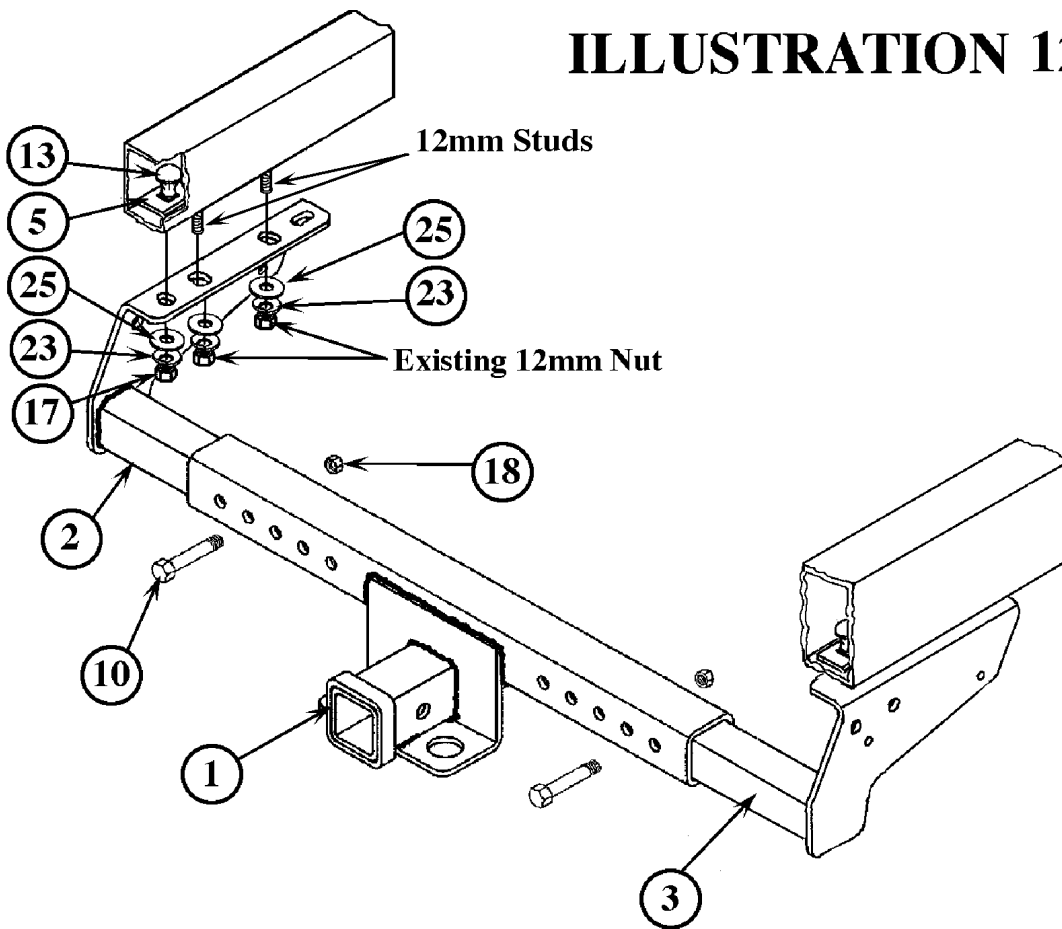

INSTALLATION 13

2001-07 JEEP LIBERTY

1. If vehicle is equipped with a gas tank protector, remove the rearmost 12mm bolt from protector frame attachment point.
2. Position hitch assembly against bottom of frame/gas tank protector so that Hole 1 is at least 1-1/4" to the rear of the 12mm weldnut in vehicle frame. Drill 1/2" attachment holes in frame using Holes 1 and 4 in hitch frame brackets.
3. Using the pull wire, insert a carriage bolt #13 and a short square hole plate #5 into vehicle frame through access hole and out through the four drilled holes.
4. Bolt hitch assembly to frame with previously installed carriage bolts extending out of frame. Bolt center receiver tube section to outer frame bracket assemblies.
5. Tighten all 1/2" bolts to 75 ft. lbs. torque. Failure to tighten bolts as described may result in fastener loss or failure.

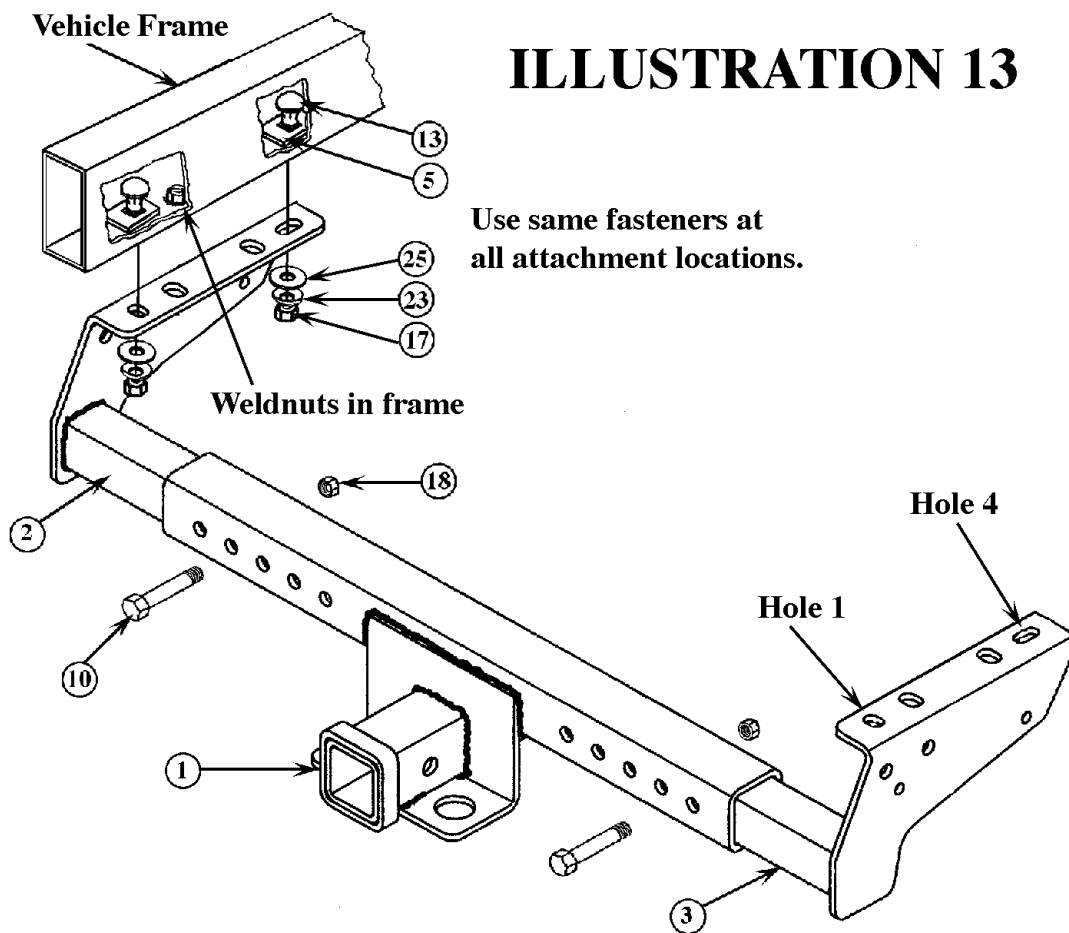

INSTALLATION 14

1983-90 FORD BRONCO II

1. Remove the rubber muffler hanger from its support rod. Remove the rod from the frame. It will no longer be used.
2. Position hitch assembly up against the bottom of vehicle frame. Using Holes 1 and 4 as guides, drill four 1/2" attachment holes in bottom of vehicle frame.
3. Place carriage bolts #13 and short square hole plates #5 into frame so that bolts drop out through previously drilled attachment holes in frame.
4. Position hitch assembly back up against frame so that bolts drop through Holes 1 and 4 in each hitch frame bracket. Bolt securely in place as illustrated.
5. Re-attach the rubber muffler support to the side of hitch frame bracket #3 with 3/8 fasteners #15 and #20. Use the second 3/8 hex nut to lock the first nut in place on bolt.
6. Tighten all 1/2" bolts to 75 ft. lbs. torque. Failure to tighten bolts as described may result in fastener loss or failure.

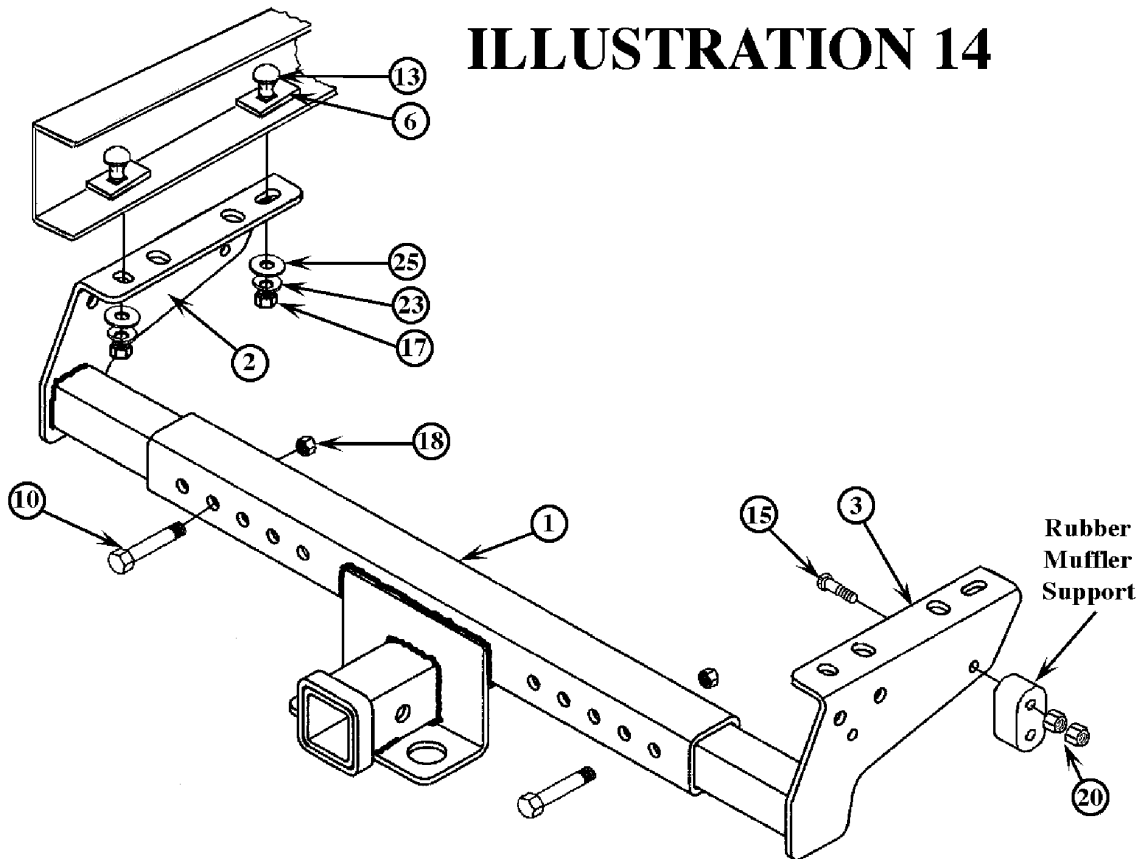

For information regarding the installation of this product, go to: www.towingsupport.com
or Email us at: tech@towingsupport.com or Call our Technical Support Team at: 1-800-344-3230

This product complies with regulation V-5, C.S.A Standard D-264 and safety requirements for connecting devices
and towing systems of the State of New York