

INSTALLATION INSTRUCTIONS

MODEL NO. 58730

Rev. 1

APPLICATION:

<u>BUICK</u>	<u>INST. NO.</u>	<u>FORD</u>	<u>INST. NO.</u>
1974-87 Century Sedan & Wagon	1	1981 Granada	1
1974-90 Estate Wagon	1	<u>GMC</u>	
1977-84 Electra Sedan	1	1978-87 Caballero	1
1974-75 LeSabre Sedan	2	<u>MERCURY</u>	
1976-83 LeSabre Sedan	1	1981 Cougar Sedan (except XR7)	1
1985 LeSabre Sedan	1	<u>OLDSMOBILE</u>	
1973-87 Regal Psgr. & 1982-83 Wagon	1	1978-87 Cutlass Sedan	1
1977-85 Riviera Sedan	1	1978-89 Cutlass Cruiser S/W	1
1975-79 Skylark, Apollo	1	1977-90 Custom Cruiser S/W	1
<u>CADILLAC</u>		1974-85 Delta 88, Royale Sedan.	1
1977-84 Coupe & Sedan DeVille	1	1974-85 98 Sedan	1
1977-92 Fleetwood	1	1979-85 Toronado	1
1979-85 El Dorado	1	1975-79 Omega	1
1978-85 Seville	1	<u>PONTIAC</u>	
1985-86 Fleetwood Brougham	1	1977-86 Bonneville, Catalina Sedan	1
<u>CHEVROLET</u>		1977-81 Catalina Safari Wagon	1
1977-85 Caprice, Impala Sedan & Wagon	1	1974-87 Grand Prix	1
1978-87 El Camino	1	1974-81 Grand Am Sedan	1
1974-83 Malibu Wagon	1	1974-81 LeMans Sedan	2
1973-77 Malibu Sedan	2	1974-81 LeMans Wagon	1
1975-79 Nova, Concours Sedan	1	1975-77 Ventura	1
<u>CHRYSLER</u>		1977-79 Phoenix	1
1978-79 Cordoba	1	1984-86 Parisienne Wagon	1
<u>DODGE</u>		1987 Safari Wagon	1
1978-79 Magnum	1		

WARNING: Although this hitch is designed to safely tow its rated load, we recommend that you consult your vehicle owner's manual for possible manufacturer's recommendations or limitations. Trailer brakes are recommended for towing loads in excess of 1500 lbs. Always follow the manufacturer's installation instructions and always install on the specified vehicle. Before installing hitch, check that the attachment points are in good condition.

Failure to follow these guidelines will void warranty. Any modifications to this hitch will void warranty.

WARNING: Use only a 5/8" diameter hitch pin with locking device to secure a ball mount in this receiver. Be sure to check the hitch pin and hair pin for positive locking placement before towing trailer.

NOTE: Some states require a clear view of license plates. Remove trailer ball and/or ball mount when not in use if it restricts view.

COMPLETE PARTS LIST			
Item	Part #	Description	Quantity
1.	2471-07	Draw Bar	1
2.	1328-02	Chain Clip Yoke	1
3.	4659-05	Yoke	1
4.	1001-03	3/16 Spacer Plate	4
5.	4443-03	Split Tube Spacer	1
6.	1848-03	3/8 Flatwasher	1
7.	1825-03	3/8 Lockwasher	1
8.	1936-03	7/16 Round Spacer	12
9.	1879-03	7/16 Lockwasher	8
10.	1861-03	7/16 Hex Nut	8
11.	1845-03	7/16 U-Bolt	4
12.	4438-03	3/8 x 2 Hex Bolt	1
13.	1888-03	1/2 Flatwasher	3
14.	1880-03	1/2 Lockwasher	4
15.	1862-03	1/2 Hex Nut	4
16.	1836-03	1/2 x 1-1/2 Hex Bolt	3
17.	1837-03	1/2 x 1-3/4 Hex Bolt	1

CLASS I

WEIGHT CARRYING HITCH CAPACITY

2,000 LBS. MAXIMUM TRAILER WEIGHT
200 LBS. MAXIMUM TONGUE WEIGHT

TOOLS RECOMMENDED TO INSTALL THIS HITCH

Electric Drill
1/2" Drill Bit
Pilot Drill (optional)
Center Punch
Hammer
11/16, 3/4, 5/8, 9/16 Sockets or end Wrenches
Torque Wrench

INSTRUCTION NO. 1

- Loosely assemble draw bar #1, chain clip-yoke #2 and yoke #3 as illustrated. On the 1981 Cadillac Seville applications, the chain clip-yoke must be attached at the hole behind the long slot. On some applications, the draw bar can be put inside yoke #3 to increase ball clearance.
- Center hitch assembly on the lower lip of bumper and back side of bumper reinforcement. On some applications, it may be necessary to remove bolts from the bumper lip which interfere with the draw bar. Also, some applications may have a wiring loom which may require re-locating.
- Using the holes in hitch parts as guides, drill 1/2" attachment holes in bumper lip and bumper reinforcement. It may be easier to drill holes if bumper is removed from the vehicle.
- After drilling the holes in Step 3, place one leg of U-bolt #11 in one drilled hole in bumper reinforcement, and mark the second attachment point to the outside of the first hole, using the other U-bolt leg as a guide. Use the same procedure for the remaining U-bolt. Drill remaining attachment holes and install U-bolts as shown on Illustration 2c on back page. Be sure to place round spacers #8 on U-bolts as illustrated.
NOTE: Some applications may have vertical supports inside the bumper which interfere with the U-bolt placement. See Illustration 1b for optional placement.
- On bumpers with a enclosed box section, U-bolts are also placed in the bottom of the bumper as done in Step 4 above.
- On bumpers with an open lower lip, attach the chain clip-yoke at previously drilled holes with hex bolts as illustrated. Be sure to place spacers #4 inside bumper lip at each attachment point.
- On bumpers with a urethane cover, a small section must be cut away before hitch can be installed. See Illustration 1a. Place one spacer #4, centered over the drilled holes in bumper lip. Mark around the spacer and cut this section of the urethane covering away so that the spacer will lay against the steel inner bumper. Install chain clip-yoke as done in Step 6 above.
- Tighten all 7/16" U-bolts to 55 ft. 3lbs torque and 1/2" bolts to 75 ft. lbs. torque. Failure to tighten bolts as described may result in fastener loss or failure.

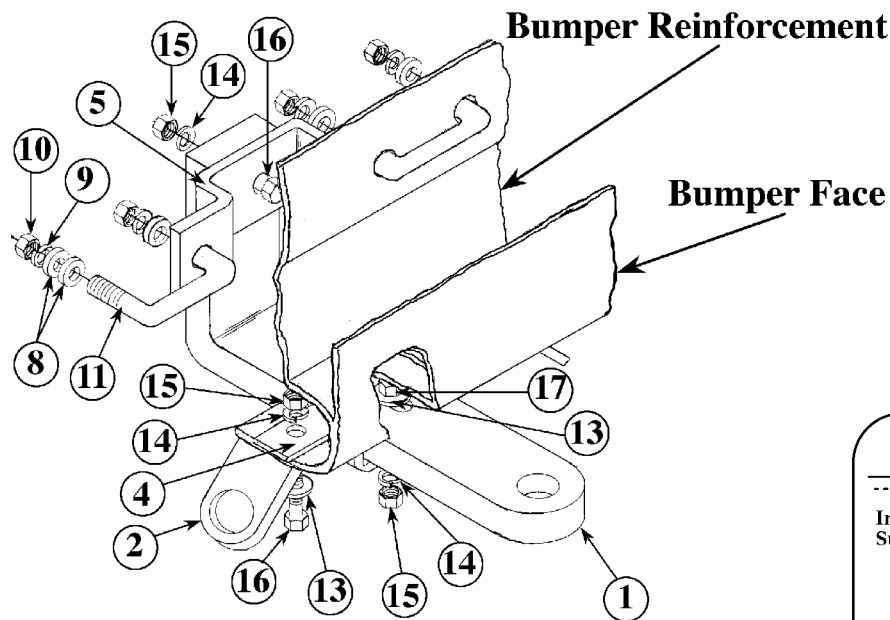

ILLUSTRATION 1

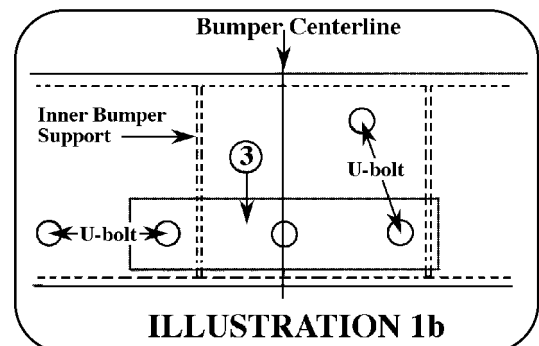
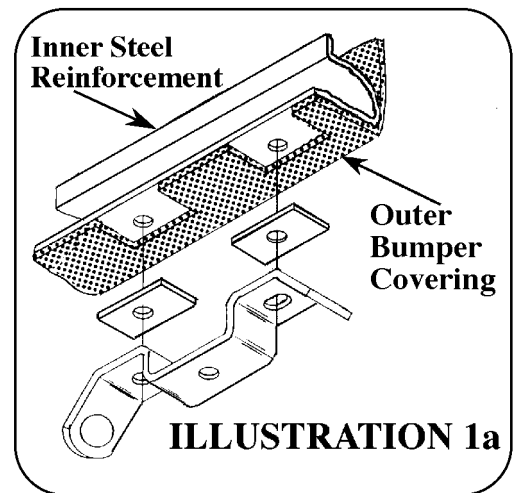
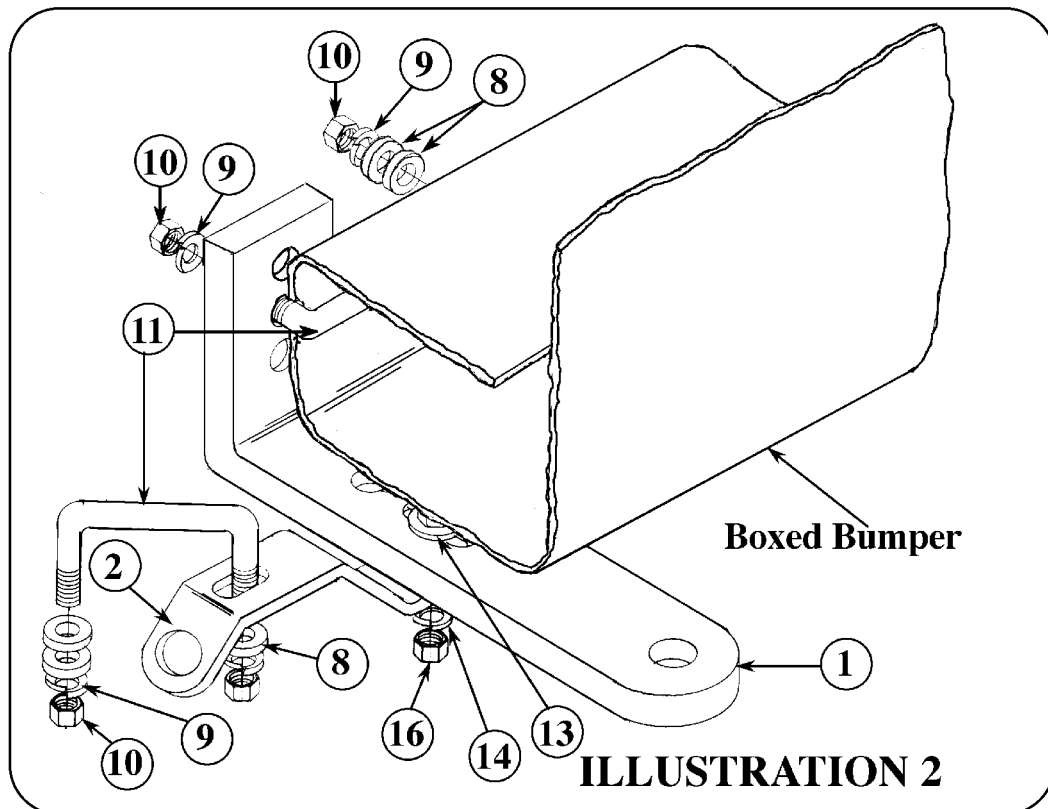
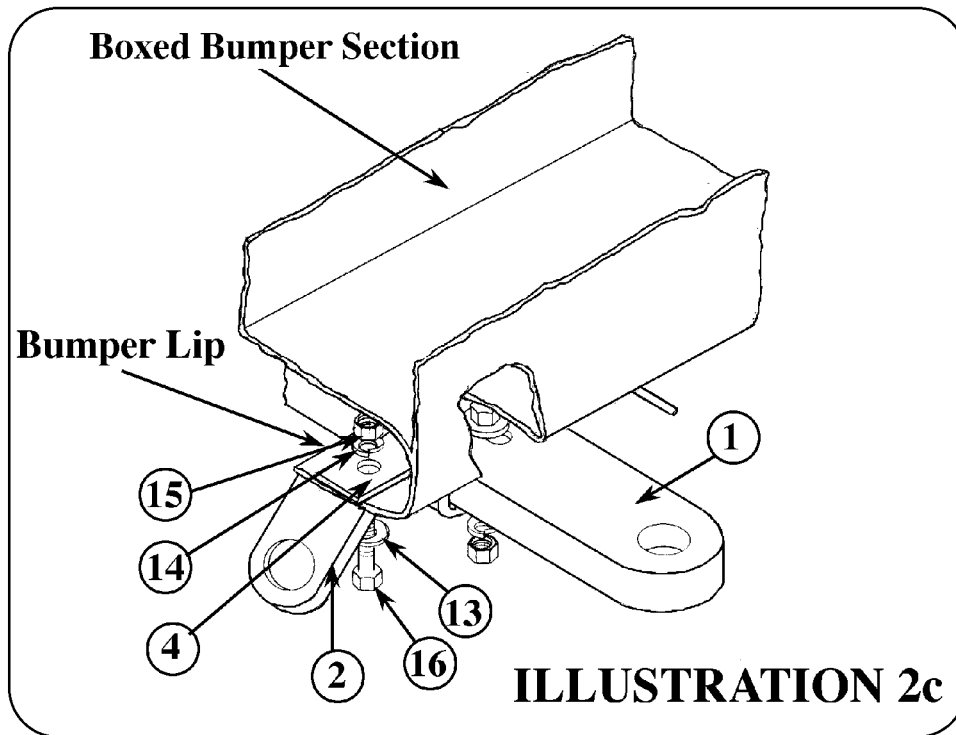
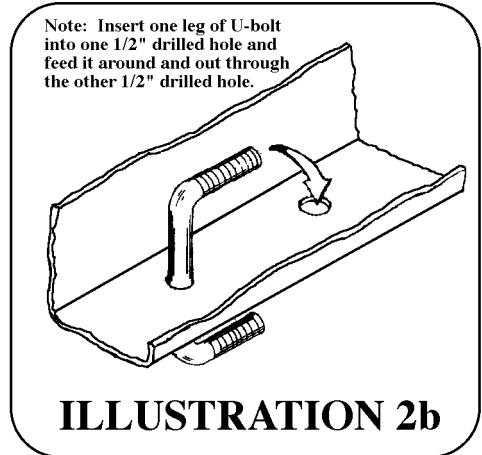
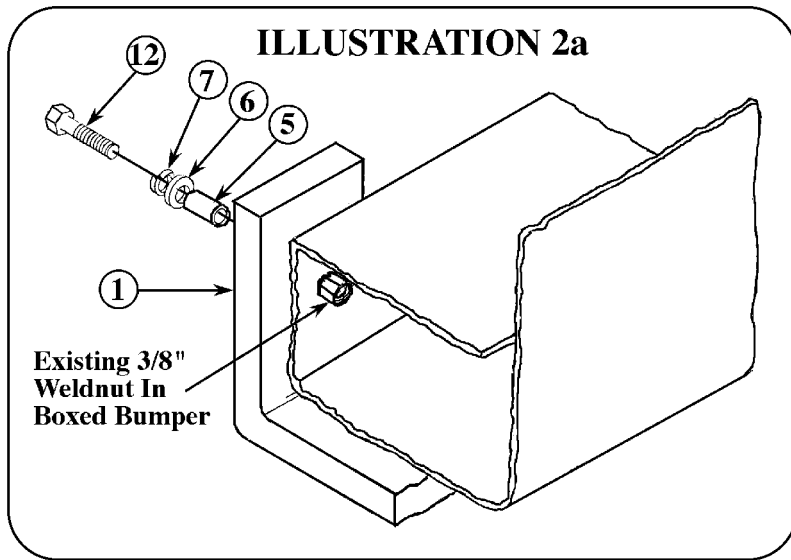

ILLUSTRATION 1b

INSTRUCTION NO. 2

1. Loosely bolt chain clip-yoke #2 to draw bar #1 at the large slot in the draw bar as illustrated.
2. Some bumpers have an existing 3/8" bolt in the center of the reinforcement section. See Illustration 2a. Remove the existing bolt and temporarily attach the draw bar to the bumper reinforcement at the existing hole. Align the chain clip-yoke against the bottom of the bumper and drill two 1/2" holes in the bumper using the holes in the chain clip-yoke as guides. Remove hitch from bumper.
3. Place one leg of a U-bolt #11 at previously drilled hole in bottom of the bumper and mark the points where the outer leg of the U-bolt rests on the bumper. Drill a 1/2" attachment hole at each of these marks.
4. Bolt the draw bar to the bumper reinforcement at the existing hole using the longer 3/8" bolt supplied. Insert U-bolts into bumper as shown on Illustration 2b and bolt chain clip-yoke securely in place.
5. On bumpers without existing 3/8" bolts in the bumper reinforcement, the hitch must be centered on the bumper and all attachment holes for hitch must be drilled.
6. Place one leg of U-bolt into drilled hole in bumper reinforcement and mark the attachment point at the outer leg. Drill a 1/2" attachment hole at this point, and install U-bolt as shown on Illustration 2b. Attach draw bar to bumper reinforcement as illustrated.
7. Tighten 7/16" U-bolts to 55 ft. lbs. torque. Tighten the 3/8" bolts, if used, to 30 ft. lbs. torque. Tighten the 1/2" bolts to 75 ft. lbs. torque. Failure to tighten bolts as described may result in fastener loss or failure.





For information regarding the installation of this product, go to: www.towingsupport.com
 or Email us at: tech@towingsupport.com or Call our Technical Support Team at: 1-800-344-3230
 This product complies with regulation V-5, C.S.A Standard D-264 and safety requirements for connecting devices
 and towing systems of the State of New York